

# 88 5531 942 Storage Island

## IMPORTANT NOTE

Carefully remove all the parts from the carton and put them individually on a soft cloth to prevent scratches or other damages occurring to the parts.

We have taken great care in the design of this product and request that you carefully and strictly follow our assembly instructions to ensure a completed product as it was designed.

Home  
Styles



## Part List

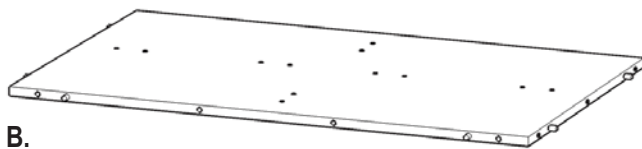

**B.**  
**Bottom**  
1 pc.

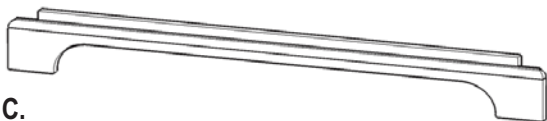

**C.**  
**Plinth**  
2 pcs.

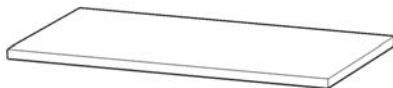

**F.**  
**Shelf**  
6 pcs.

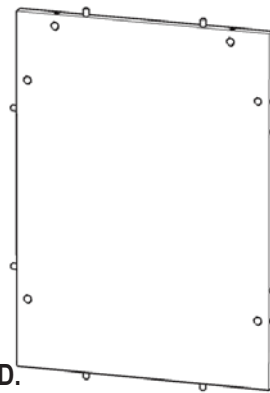

**D.**  
**Back Panel**  
1 pc.

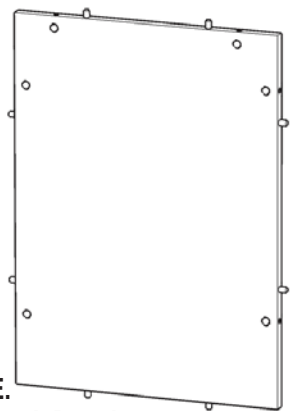

**E.**  
**Back Panel**  
1 pc.

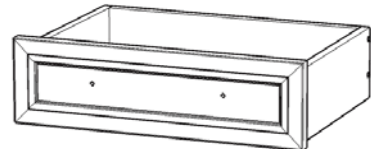

**G.**  
**Drawer**  
6 pcs.

(Knock-Down Construction, please refer to the last page of instructions for steps to complete drawer assembly)

## Hardware List



**Hex Wrench**  
1 pc.



**Small Hex Wrench**  
1 pc.



**Cam Lock**  
48 pcs. (+6 extra)



**Spring Washer**  
6 pcs. (+1 extra)



**Flat Washer**  
6 pcs. (+1 extra)



**Cam Lock Screw**  
48 pcs. (+1 extra)



**M6x35 Bolt**  
6 pcs. (+1 extra)



**Adjustable Pin**  
24 pcs. (+1 extra)



**M3.5x16 Wood Screw (short) for Drawer Base Part**  
30 pcs. (+1 extra)



**M4x20 Machine Screw**  
20 pcs.



**M3.5x25 Wood Screw (long) for Drawer Side Part**  
40 pcs. (+1 extra)



**Knob for Drawer N**  
8 pcs.

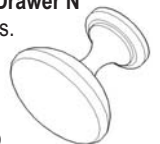

**Knob for Drawer G**  
12 pcs.

**For assembly see instructions in carton 88 5531 941, 88 5531 943**

Tools required for assembly: **Phillips** screwdriver

Tools recommended for assembly: Level

**Home Styles Consumer Assistance Line 888-680-7460 and 877-831-0319**

**servicedesk@homestyles-furniture.com**

## IMPORTANT

- \* Do not tighten up all the screws until each part is properly assembled.
- \* You should keep Hex Wrench in a safe place as you may need to tighten up the Head Cap Bolts in the future.
- \* After assembly item must be level to work properly. Use the included adjustable levelers to level.

## STEP 1

Put Cam Lock Screws into the pre-drilled holes of Top (A), Plinths (C), Side Panels (H),(I) and Middle Panel (J) and tighten. (see Figure 1)

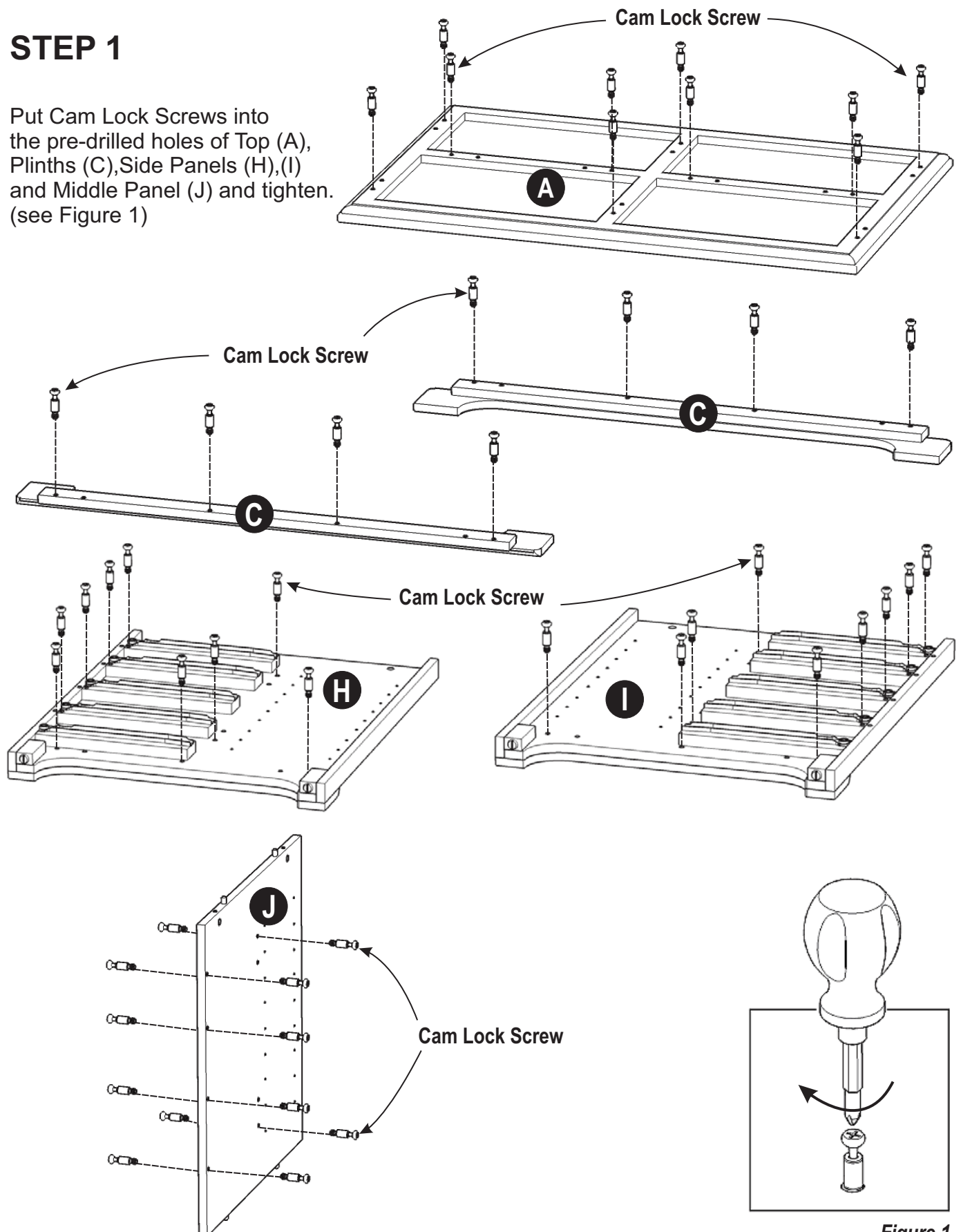

Figure 1

## STEP 2

Attach Bottom (B) to Side Panel (H) using Cam Locks.  
(see Figure 2)

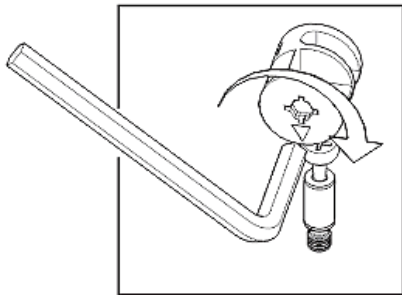

Figure 2

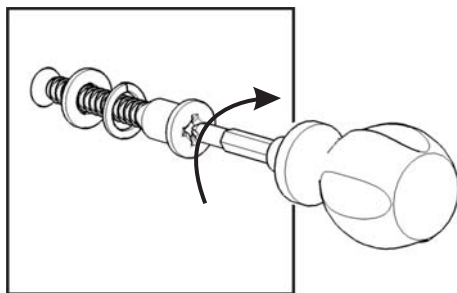
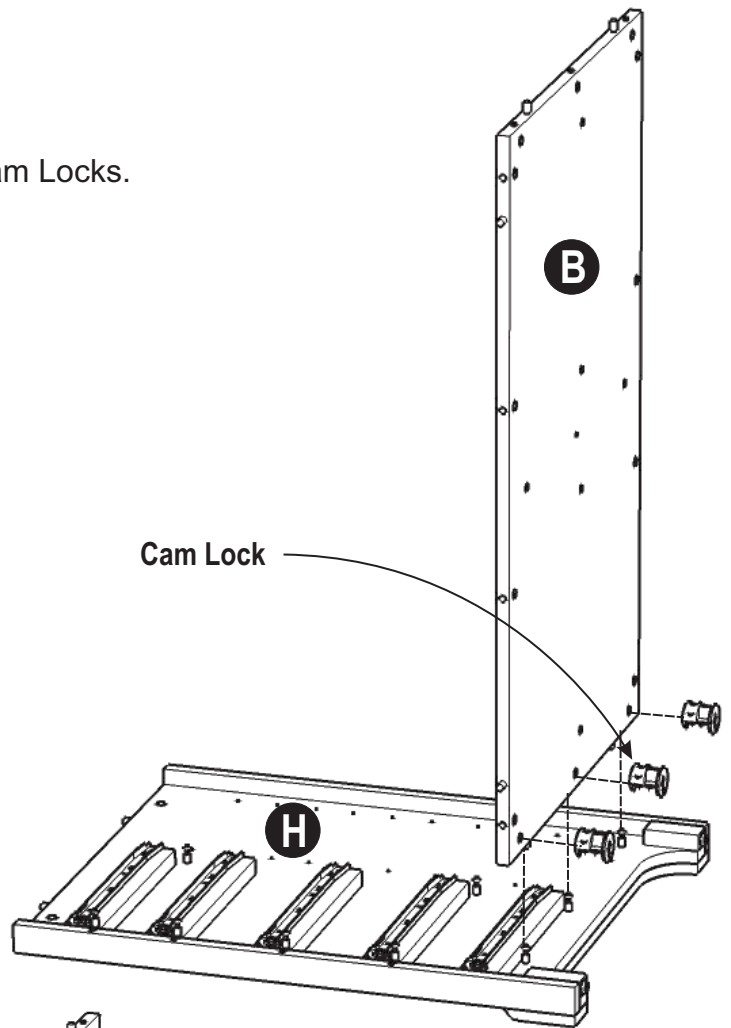
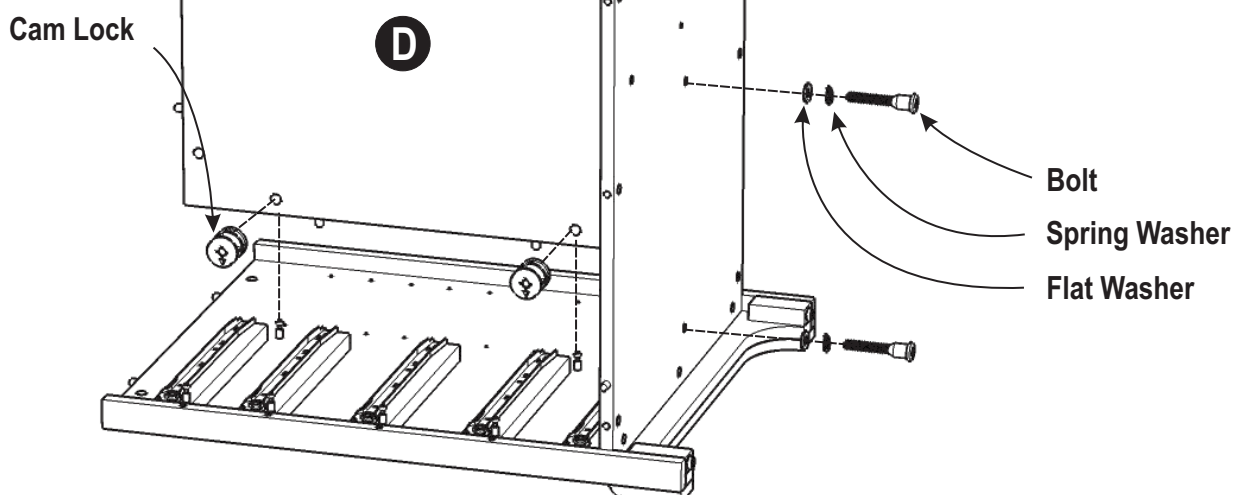

Figure 3



## STEP 3

Attach Back Panel (D) to unit with Cam Locks, Flat Washers, Spring Washers and Bolts.  
(see Figure 3)



## STEP 4

Attach Front Rails (K) to unit using Cam Locks.

Attach Middle Panel (J) to unit with Cam Locks, Flat Washers, Spring Washers and Bolts.

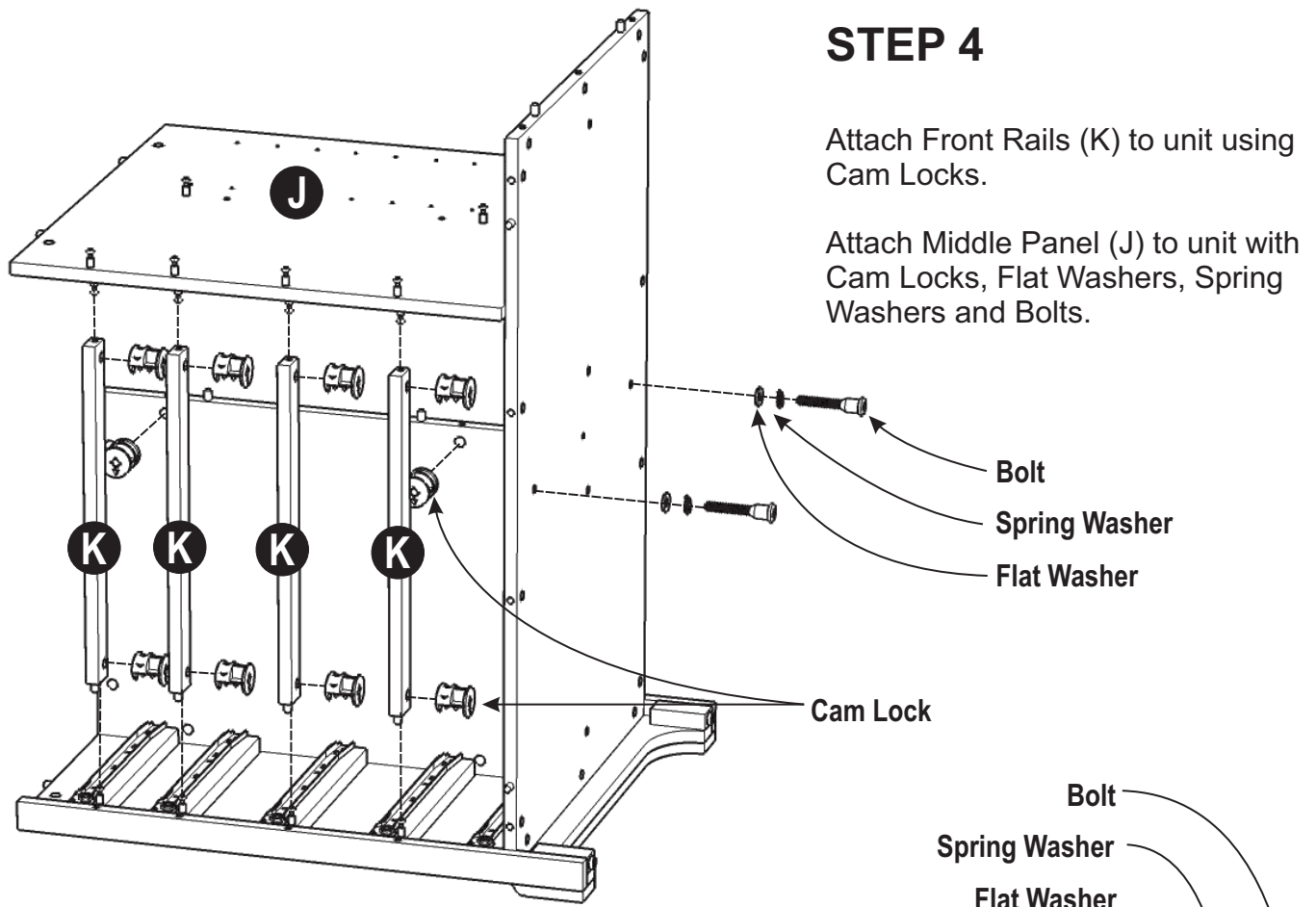

## STEP 5

Attach Front Rails (L) to unit using Cam Locks.

Attach Back Panel (E) to unit with Cam Locks, Flat Washers, Spring Washers and Bolts.

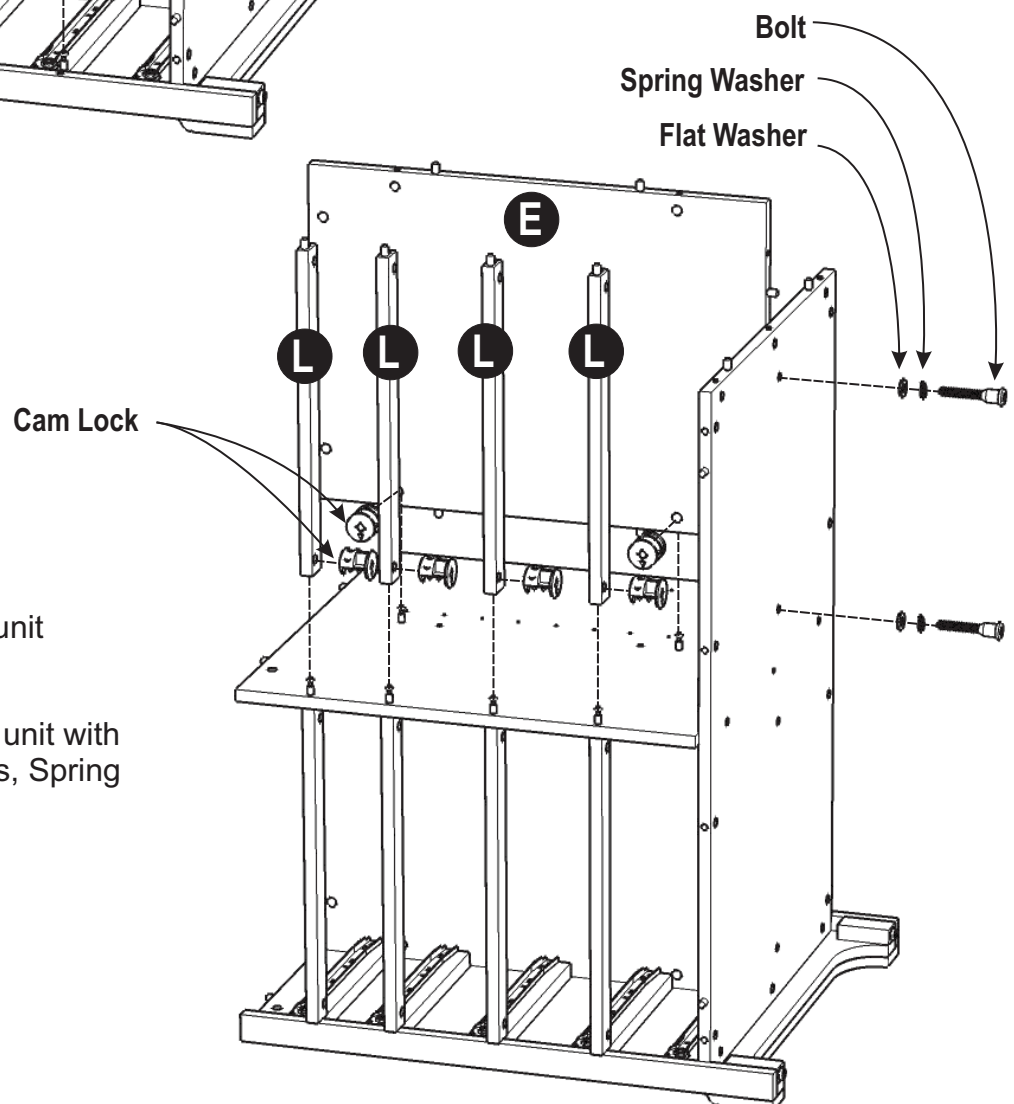

## STEP 6

Attach Side Panel (I) to unit with Cam Locks.

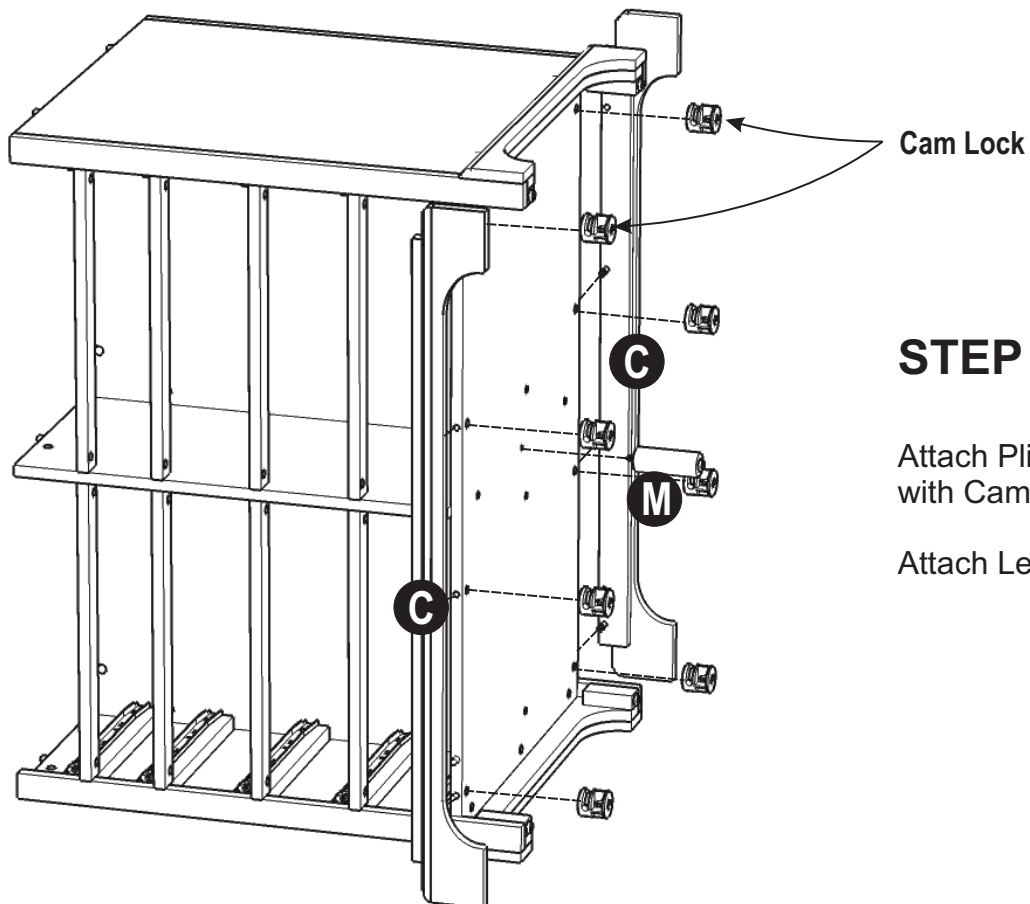
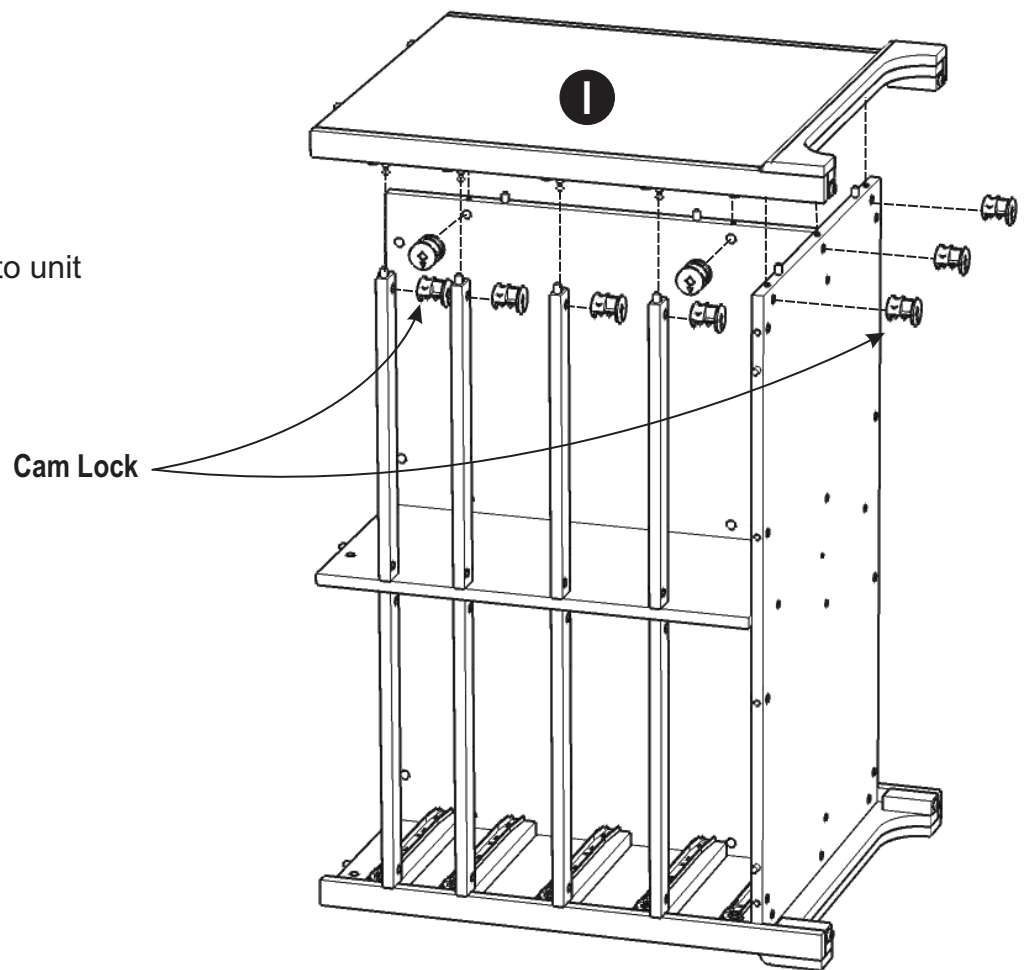

## STEP 7

Attach Plinths (C) to unit with Cam Locks.

Attach Leg Support (M) to unit.

## STEP 8

Attach Top (A) to unit with Cam Locks.

Cam Lock

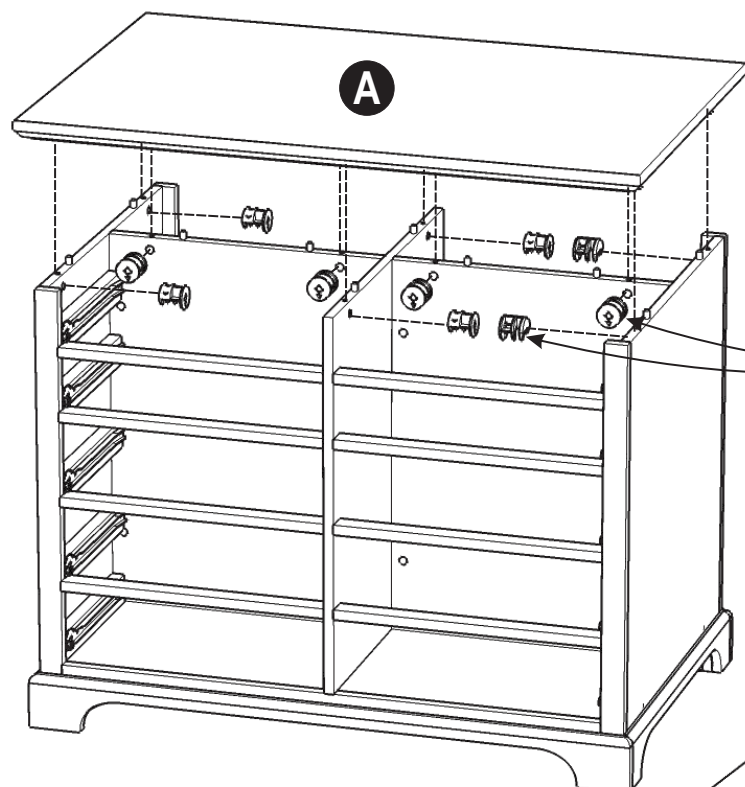

## STEP 9

Insert Adjustable Pins into side panels and middle panel at desired level, then place shelves (F) into position.

Adjustable Pin

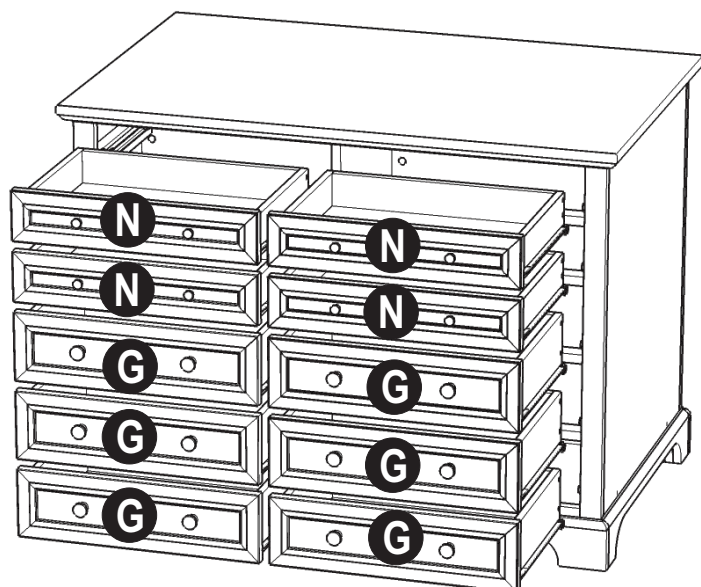
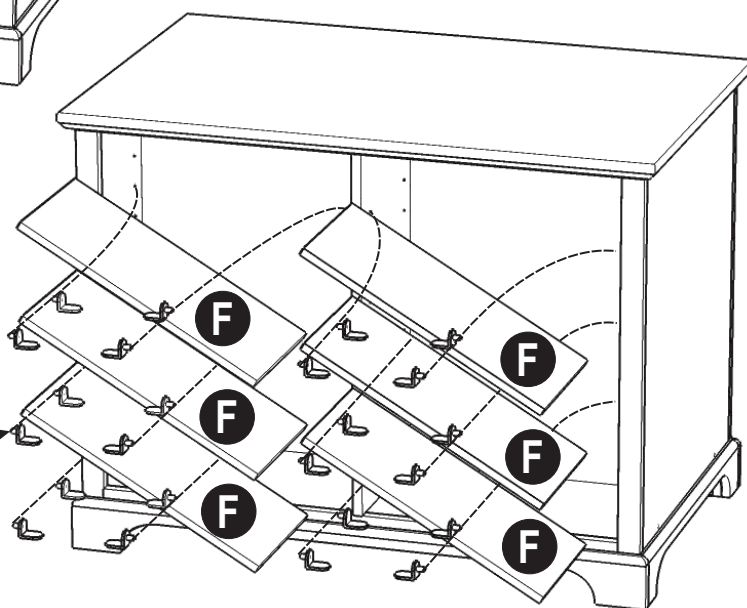

## STEP 10

Slide Drawers (N) and (G) into position.

To level the unit, adjust the adjustable levelers on the bottom of unit. (see Figure 4)

**Note: Unit must be level to work properly.**

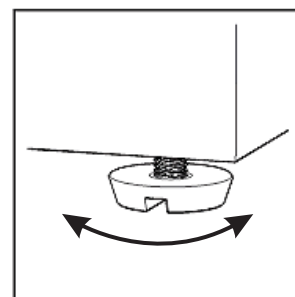
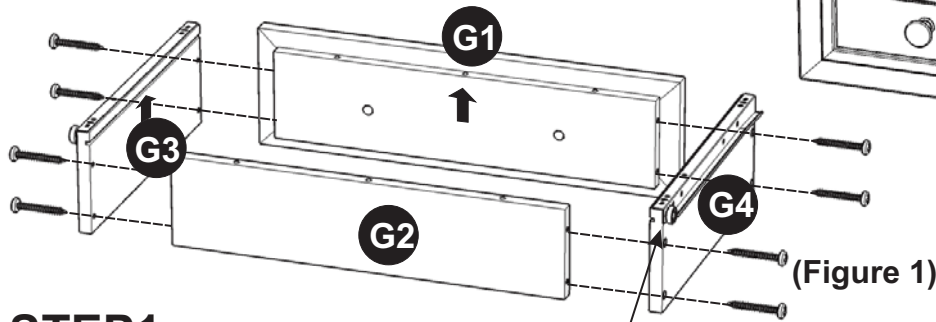

Figure 4



# Drawer G



## STEP 1

Attach G1 to G3 and G4, using a Phillips screwdriver and long wood screws (4X), tighten halfway.

Attach G2 to G3 and G4 using long wood screws (4X), tighten halfway. (See Figure 1)

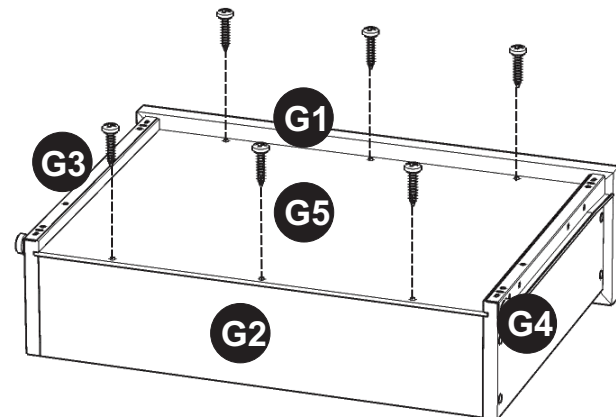

(Figure 3)

## STEP 3

Insert short wood screws (6X) into the pre-drilled holes in G5, tighten screws. (See Figure 3)

(Figure 2)

## STEP 4

Attach hardware pulls with machine screws. (See Figure 4)

## STEP 2

Slide G5 into the grooves in G3 and G4. Be sure to push G5 all the way forward so it meets G1. (See Figure 2)

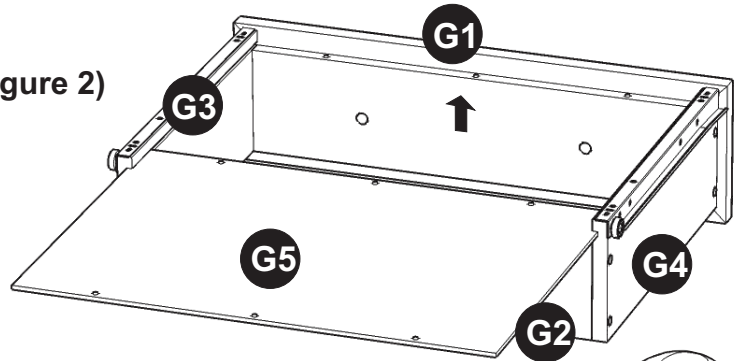

(Figure 4)

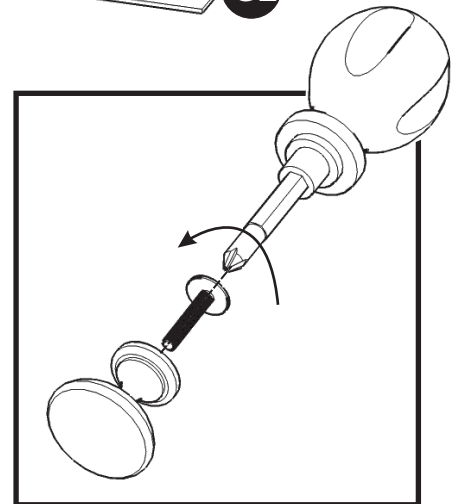

Tighten all screws used in drawer assembly.

## Part List

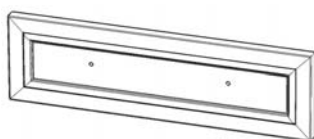

G1.  
Front Part  
6 pcs.

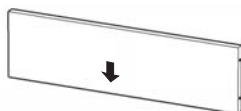

G2.  
Back Part  
6 pcs.

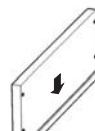

G3.  
Side Part  
6 pcs.



G4.  
Side Part  
6 pcs.



G5.  
Base Part  
6 pcs.

# Drawer N

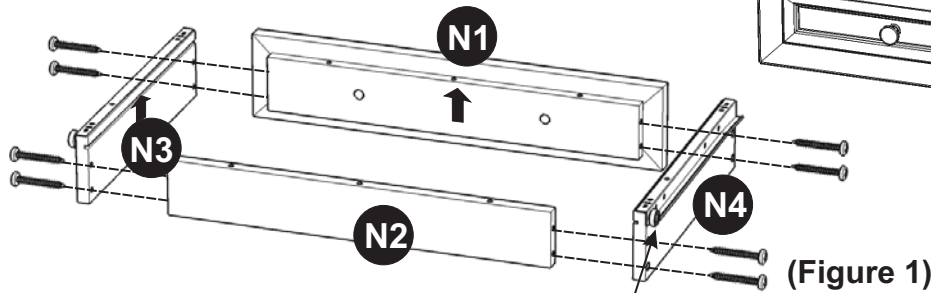

## STEP 1

Attach N1 to N3 and N4, using a Phillips screwdriver and long wood screws (4X), tighten halfway.

Attach N2 to N3 and N4 using long wood screws (4X), tighten halfway. (See Figure 1)

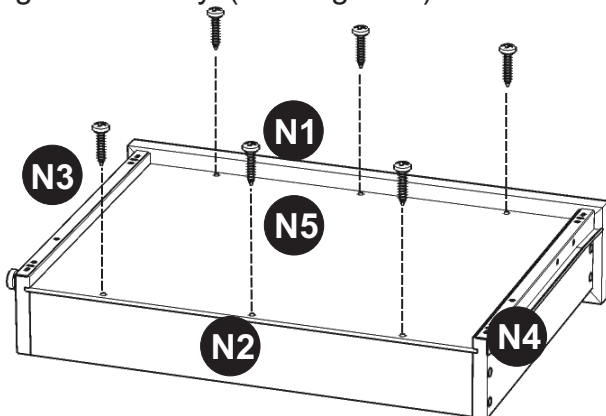

## STEP 3

Insert short wood screws (6X) into the pre-drilled holes in N5, tighten screws. (See Figure 3)

## STEP 2

Slide N5 into the grooves in N3 and N4. Be sure to push N5 all the way forward so it meets N1. (See Figure 2)

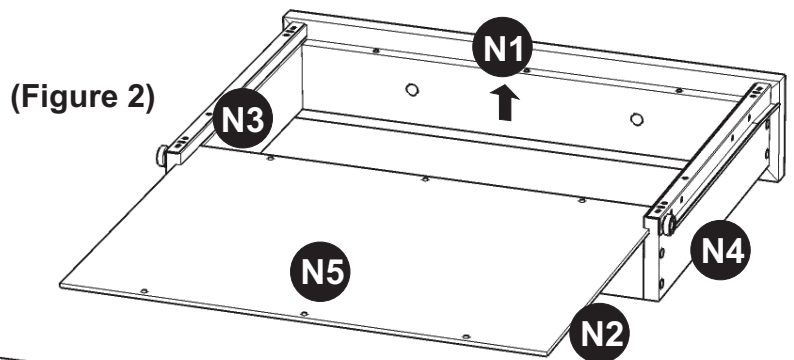

(Figure 4)

## STEP 4

Attach hardware pulls with machine screws. (See Figure 4)

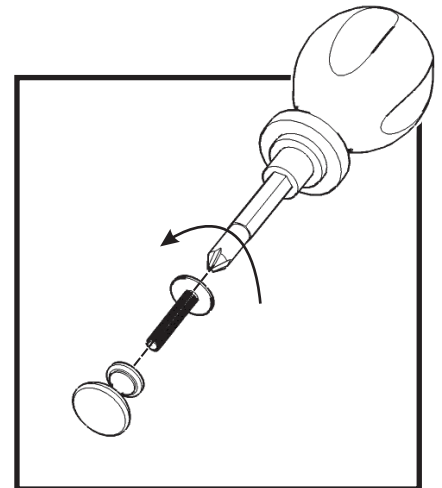

Tighten all screws used in drawer assembly.

## Part List

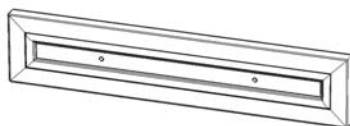

N1.  
Front Part  
4 pcs.

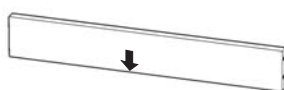

N2.  
Back Part  
4 pcs.



N3.  
Side Part  
4 pcs.



N4.  
Side Part  
4 pcs.



N5.  
Base Part  
4 pcs.